

PRODUCT DATA SHEET

POLY STUDS



Concentric Classic PolyStud Grey

Clearview Tactiles series are designed to be installed onto pedestrian surfaces to assist in the orientation of people who are vision impaired and to give tactile warning to safely navigate around in a built environment - detectable underfoot or by cane.

SPECIFICATIONS

PRODUCT	<b>Poly Tactile Stud</b>
CODE	<b>CCPS1G</b>
MATERIAL	High Impact Thermoprene (Poly)
TOP PROFILE	Concentric rings, plain sides
OVERALL DIMENSIONS	35mm x 5mm
PRODUCT WARRANTY	4 years (As per Clearview's Standard Warranty)
SLIP RATING	P5
CODE COMPLIANCE	AS/NZS1428.4.1:2009, BCA 2014 (Subject to surrounding floor finish luminance)
FIXING METHOD	Adhesive or Mechanical

PROFILE

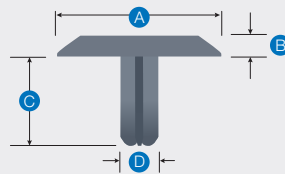

A	35mm
B	5mm
C	20mm
D	8mm



STANDARD COLOURS

Finish



GREY

TYPICAL INSTALLATION

Fix with adhesive or mechanical

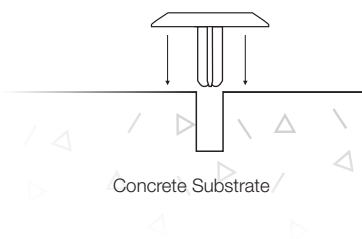

HOW TO SPECIFY

Copy the prewritten specification below and update all sections in brackets to create your project specification.

Description

Clearview Tactile Ground Indicator Studs in code: CCPS1G (High Impact Thermoprene Poly). To be installed to the manufacturer's instructions in accordance to the AS/NZS 1428.1.4.2009

Manufacturer

Clearview Tactiles  
P: 1300 884 948  
E: sales@clearviewtactiles.com.au  
W: www.clearviewtactiles.com.au

Example - Typical Specification

Clearview Tactile Ground Indicator Stud Code CCPS1G - High Impact Thermoprene Poly. To be installed in accordance to the manufacturer's instructions in accordance to the AS/NZS 1428.1.4.2009